

Step 1

Look for a nice spot for your Billy-Billy.

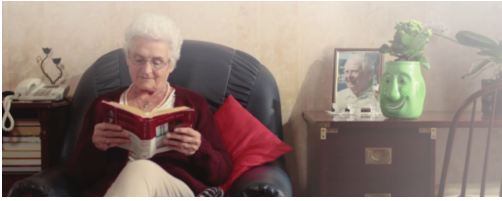

Step 2



Connect the power plug and softly press the on/off switch to start up your Billy-Billy.

- Billy-Billy's cheeks will stay red during the start up. This takes about 1 minute. When Billy-Billy is ready for use he will ask you in English, Dutch and French which language you prefer. Do not reply if the heard language is not the one you want. The next language will follow. The robot will reboot after you confirmed the language.

Step 3



- After restarting, when the cheeks turn green Billy-Billy will let you know that the start-up is completed and will speak and understand English.

- Once Billy-Billy is restarted and says he is ready for use, you can for instance ask Billy-Billy what time it is. This is done by saying "Billy-Billy" first and waiting until his cheeks turn blue. After that you can ask: "What time is it?".



- If Billy-Billy understood you, the cheeks will turn purple and he will tell you the time.

Step 4

Perform the following steps to connect Billy-Billy to a wifi network:

- Use ZBOS Control to create a file with the information for the wifi network. Surf to the website <https://control.zorabots.be/> using your browser.

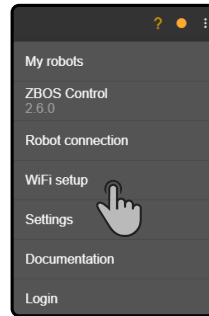

Tap the option 'WiFi setup' and enter the information for your wifi network⁽¹⁾ and download the file⁽²⁾

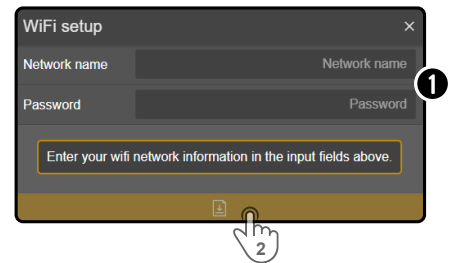

Copy the downloaded file to a usb-drive.



Insert the usb-drive into a usb slot at the back of Billy-billy.

Say 'OK Billy-Billy' to make Billy start listening and then state the command 'connect to wifi' to connect Billy-Billy to the wifi network.

Step 5

Link Billy-Billy to the ZBOS Control app. Scan a code below to install the app on your smartphone or tablet.



For more information on using the app, please refer to the manual on the website <https://docs.zorabots.be>.



Step 6

ATTENTION! Your Billy-Billy will regularly check if a software update is available. If this is the case, the update will automatically be installed. This is necessary to improve your Billy-Billy and to constantly add new features.

●●● During the update the cheeks of the Billy-Billy will blink blue, green and red.

Make sure you don't switch off Billy-Billy during an update. Billy-Billy will notify you when the update is successful.

Step 7

Prepare your Billy-Billy for the first plant. Use the following steps:

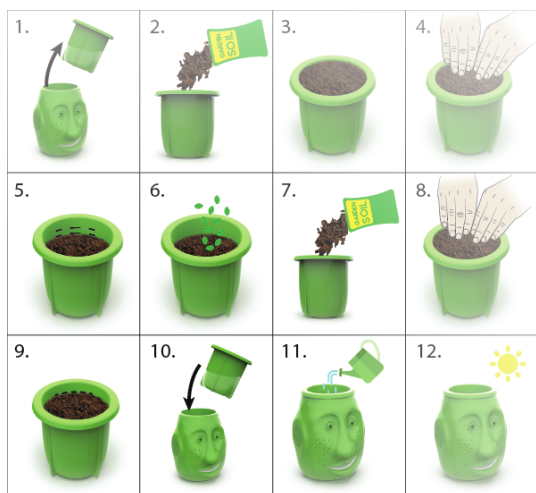

Colour codes cheeks Billy-Billy

Colour	Function when coloured	Function when blinking
●	Everything is ok with Billy-Billy. No actions are necessary	Billy-Billy is waiting for the re-insertion of the inner pot.
●	Billy-Billy heard his "wake word" and is waiting for a command.	Please wait a little while, Billy-Billy is busy.
●	Billy-Billy needs help. Ask Billy-Billy if everything is OK.	
●	Billy-Billy is starting up or shutting down.	
●	Billy-Billy is talking.	
● ● ●	Billy-Billy is updating.	

Billy-Billy commands

Say "Billy-Billy"

- Are you thirsty?
- Hello Billy-Billy.
- What time is it?
- What is your IP address?
- Do you have enough light?
- Is it warm enough?
- Introduce yourself.
- Is everything okay?
- How much water do you have?
- What is your temperature?
- Can you repeat?
- What day are we today?
- What is the meaning of life?
- What is your plant name?
- What's the weather for today?
- What are today's headlines?

Note: The entire list of everything you can ask Billy-Billy can be found on the website: <https://docs.zorabots.be>